

# PARTITION SOUND INSULATION

## STANDARD M

ON SINGLE FRAME

from typical technical solutions album of Technosonus and NIISF  
version TS/01.2020/RD/S/R4 type S-4.1

### components:

- PPN 50/40, PS 50/50 AcousticGyps reinforced profile
- V-100 vibrodamping tape
- Sealing tape
- AcousticGyps GKLZ 12.5 mm
- Tecsound membrane (Tecsound SY) / Zvukoizol VEM smk
- StopZvuk BP/Eco sound-absorbing board
- TS-DG 6/60 Dowel pin · Vibrowasher
- TS-XTN 3.9x23, TS-XTN 3.9x38, TS-MM 4.2-13 self-tapping screws
- Sonetik vibroacoustic sealant
- Bautger glue



SYSTEM  
THICKNESS  
**113 mm**



AIRBORNE NOISE  
REDUCTION  
**Rw = 58 dB**

Modern efficient system for sound insulation of two premises from each other. For use in hotels, cabinets, meeting rooms, production shops, etc. Provides maximum protection of a premise against airborne noise.



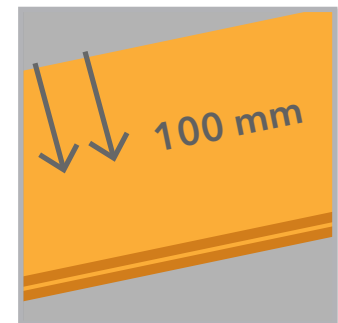
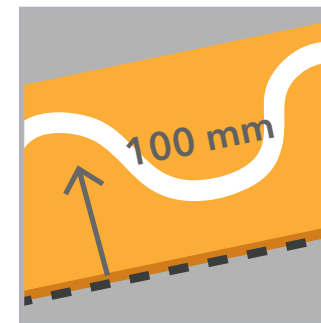
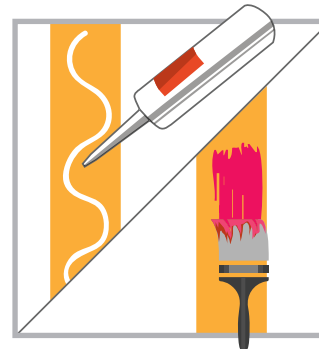
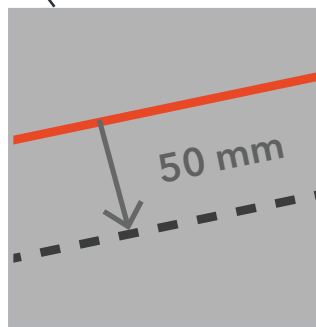
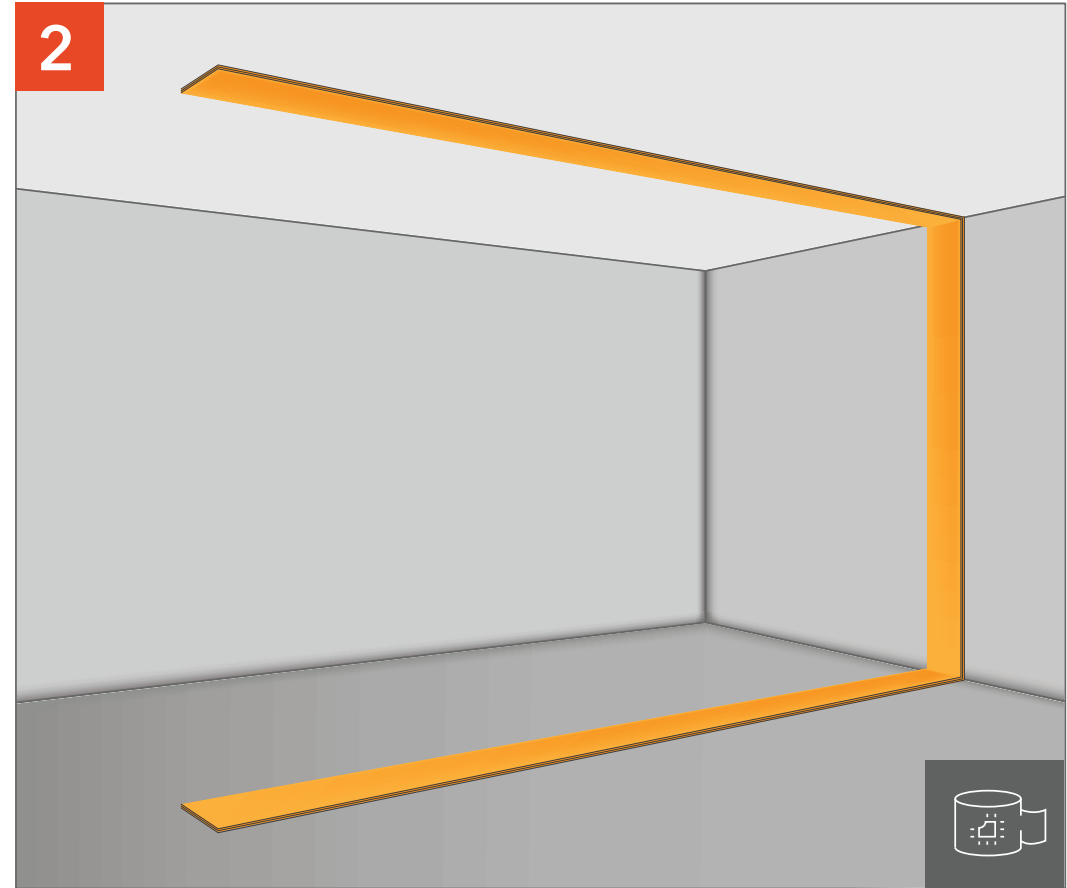
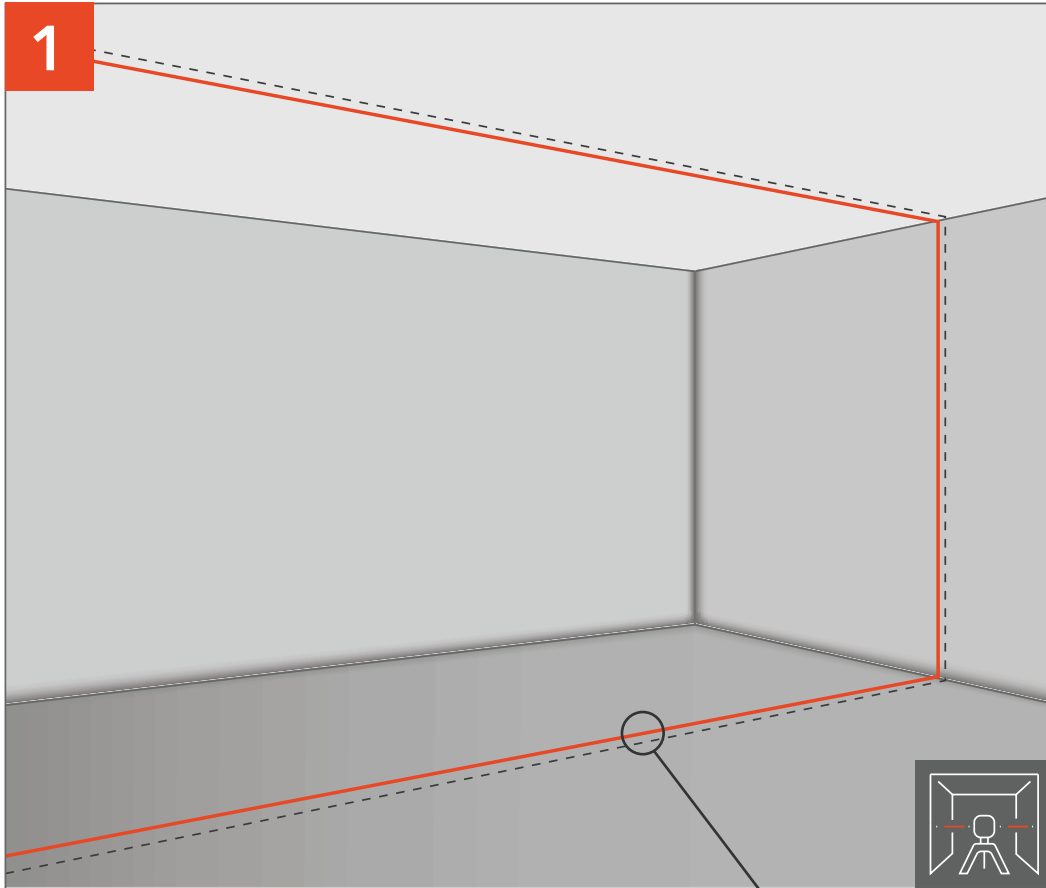

Mark the center line of the partition.

Glue StopZvuk V100 tape using Sonetik vibroacoustic sealant or Bautger glue.

## STANDARD M PARTITION SOUND INSULATION

# STANDARD M PARTITION SOUND INSULATION

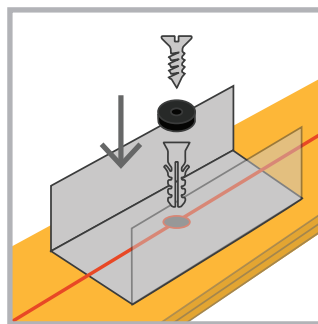
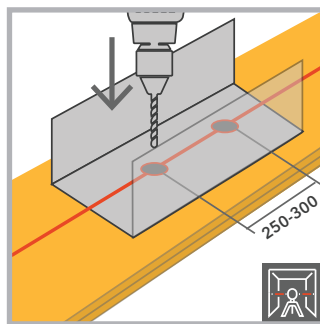
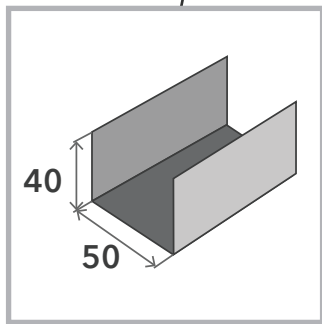
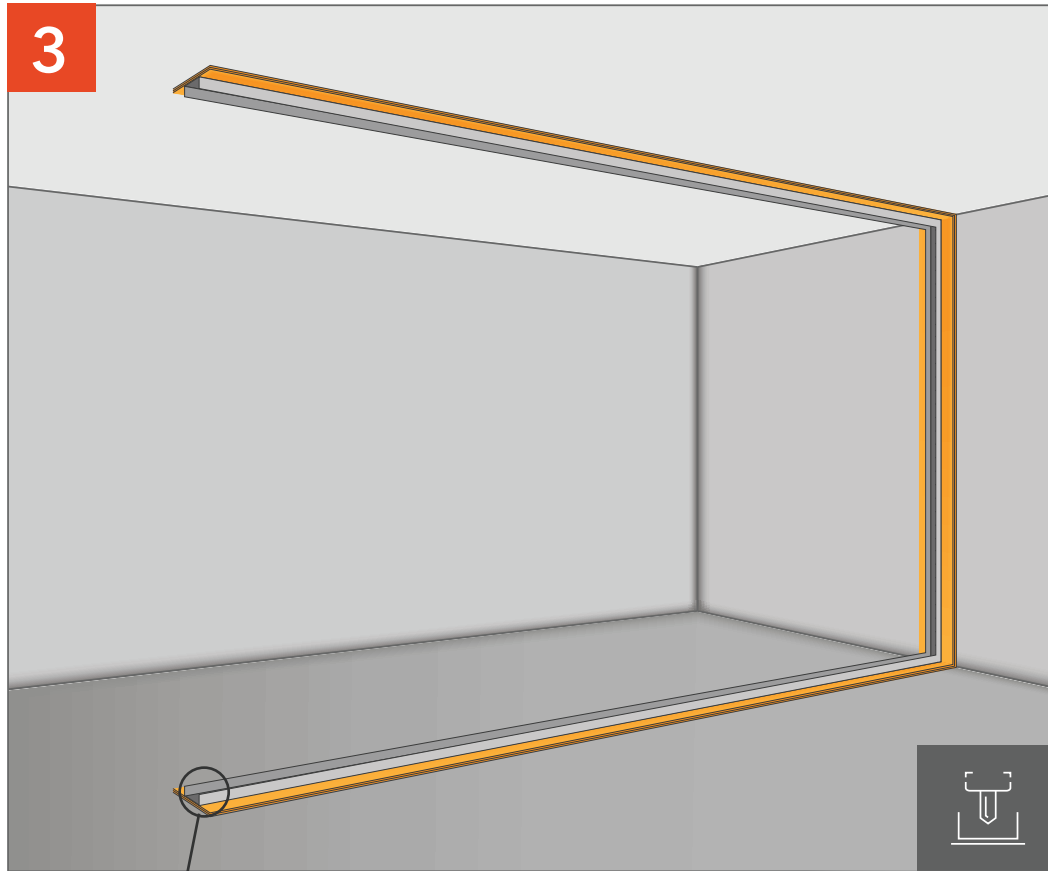

Fasten PN profile with 250-300 mm pitch between the dowel pins.

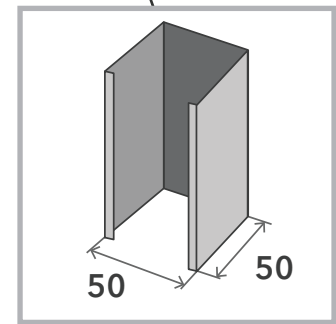
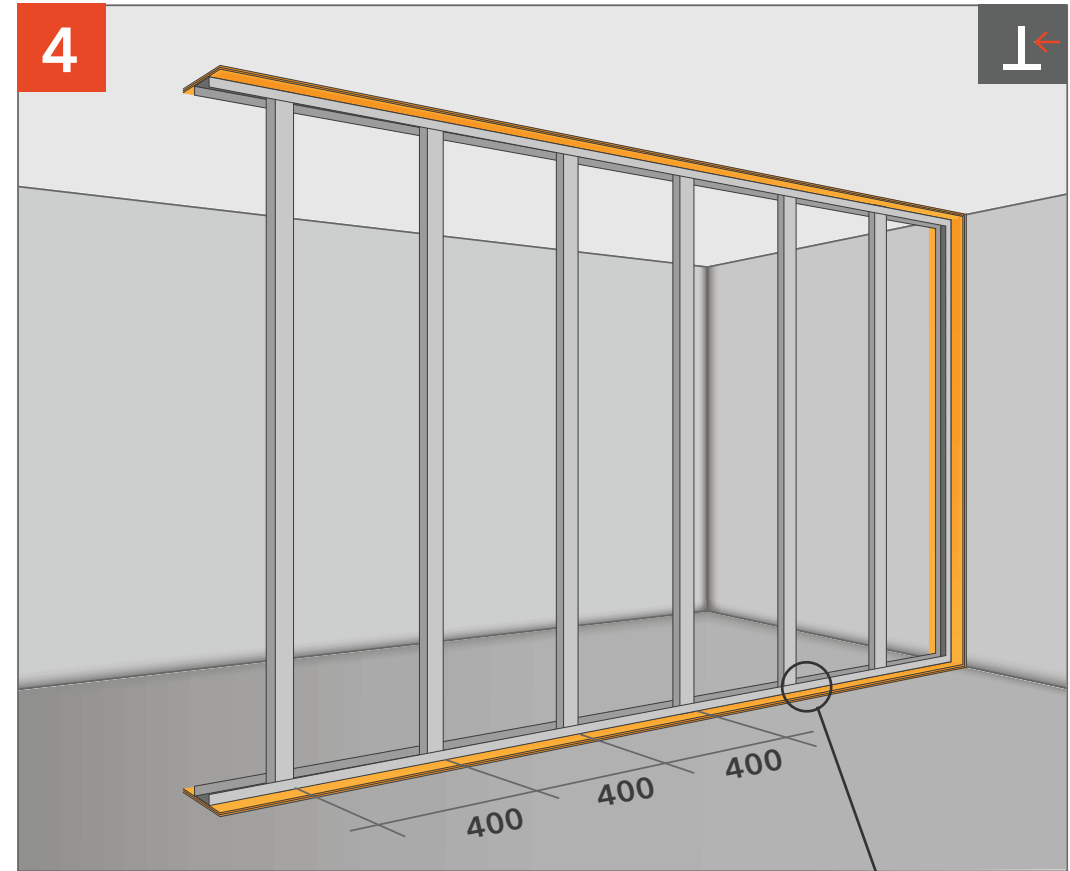

Mount PS profile with 400 mm pitch.

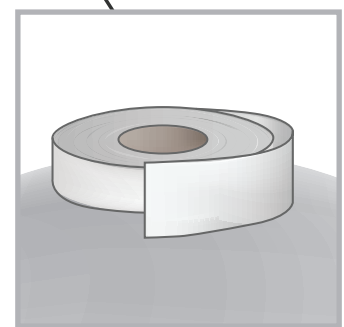
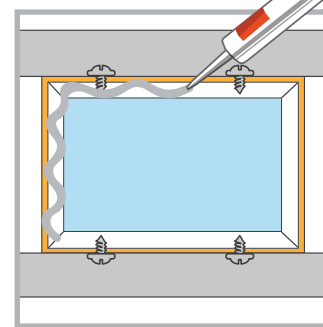
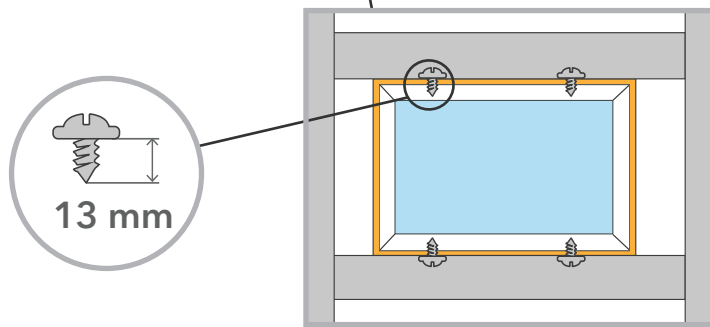
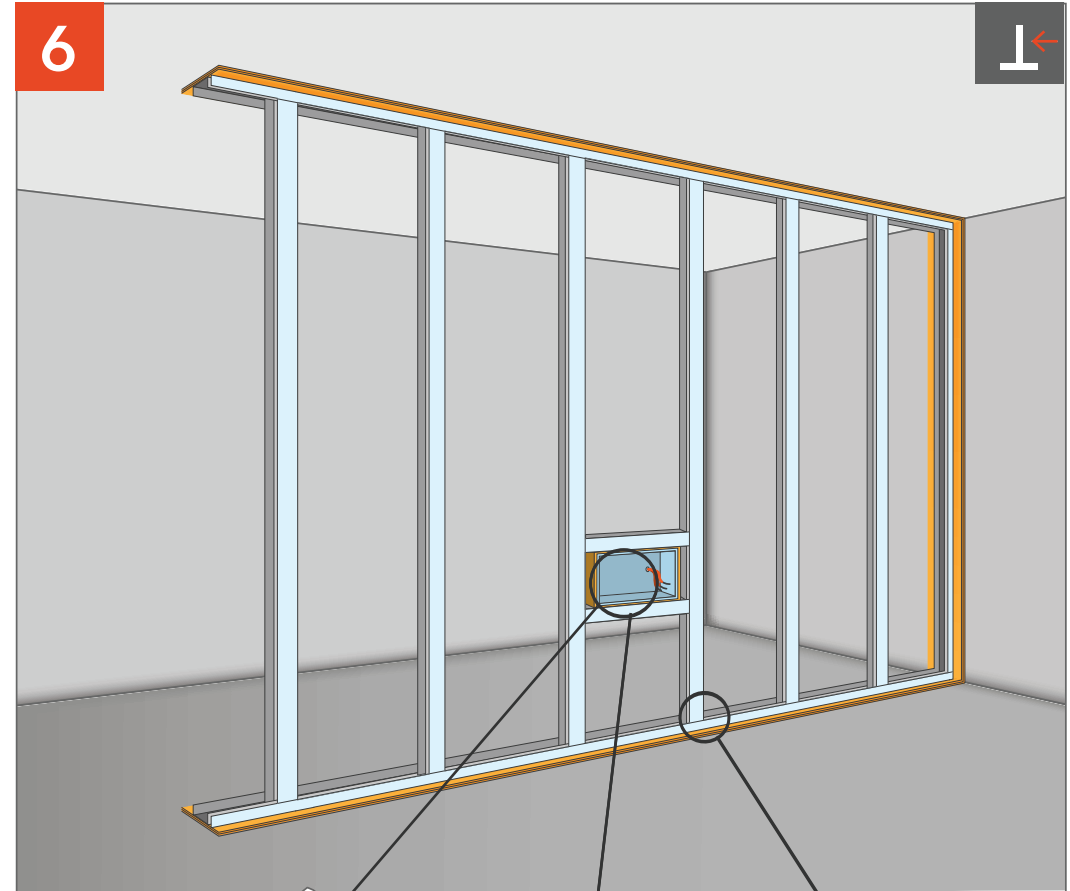
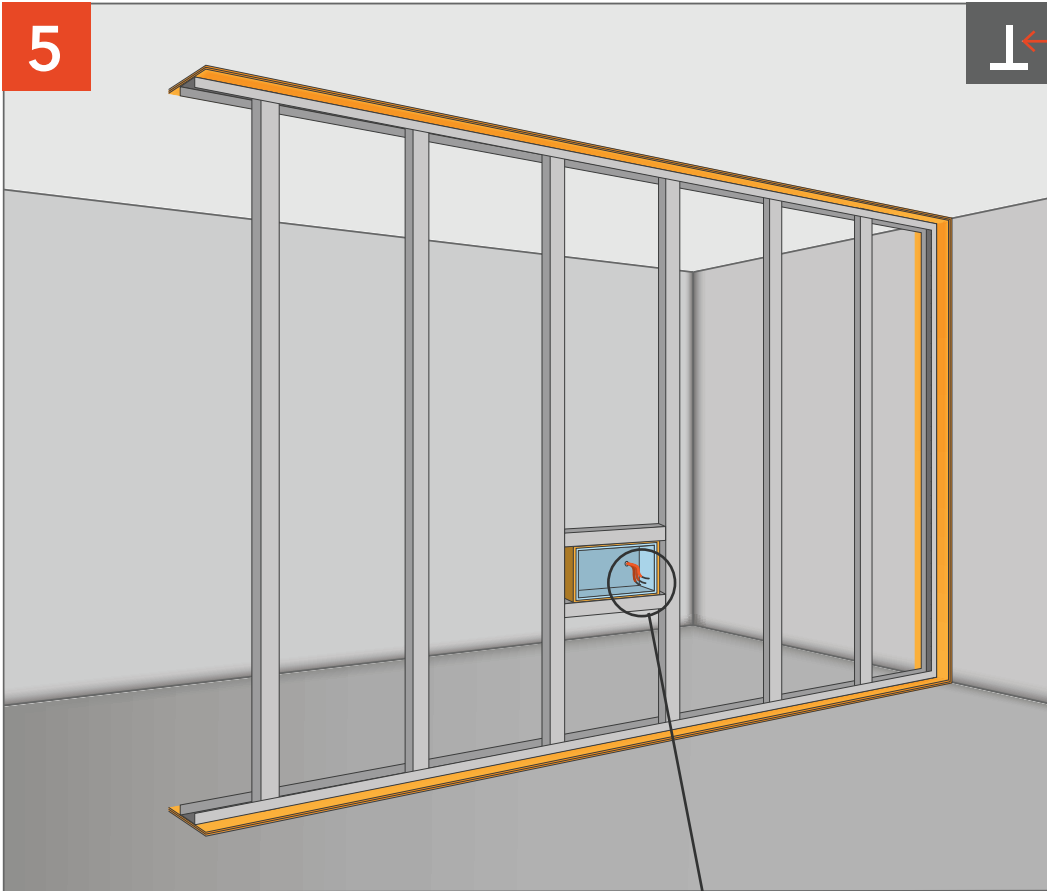

Mount AcousticGypsum Outlet Box in a prepared profile frame.

Glue the frame with damper tape.  
Apply Sonetik vibroacoustic sealant to the surface of the outlet box.

## STANDARD M PARTITION SOUND INSULATION

# STANDARD M PARTITION SOUND INSULATION

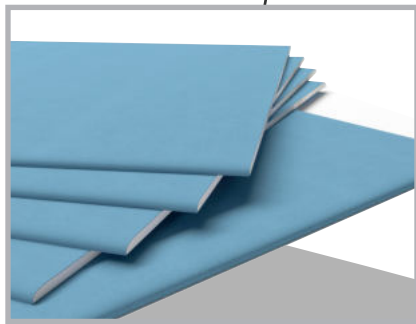
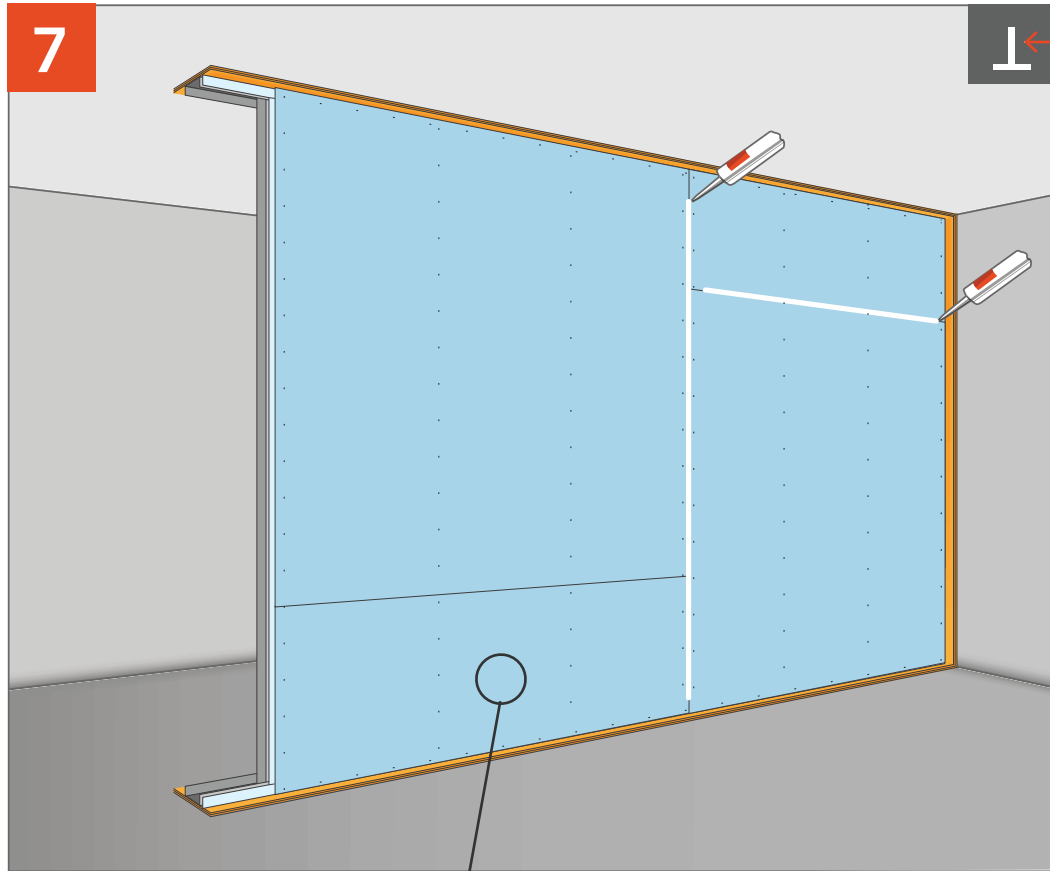

Mount the first layer of AcousticGypsum GKZ and cover the joints of the sheets with Sonetik vibroacoustic sealant.

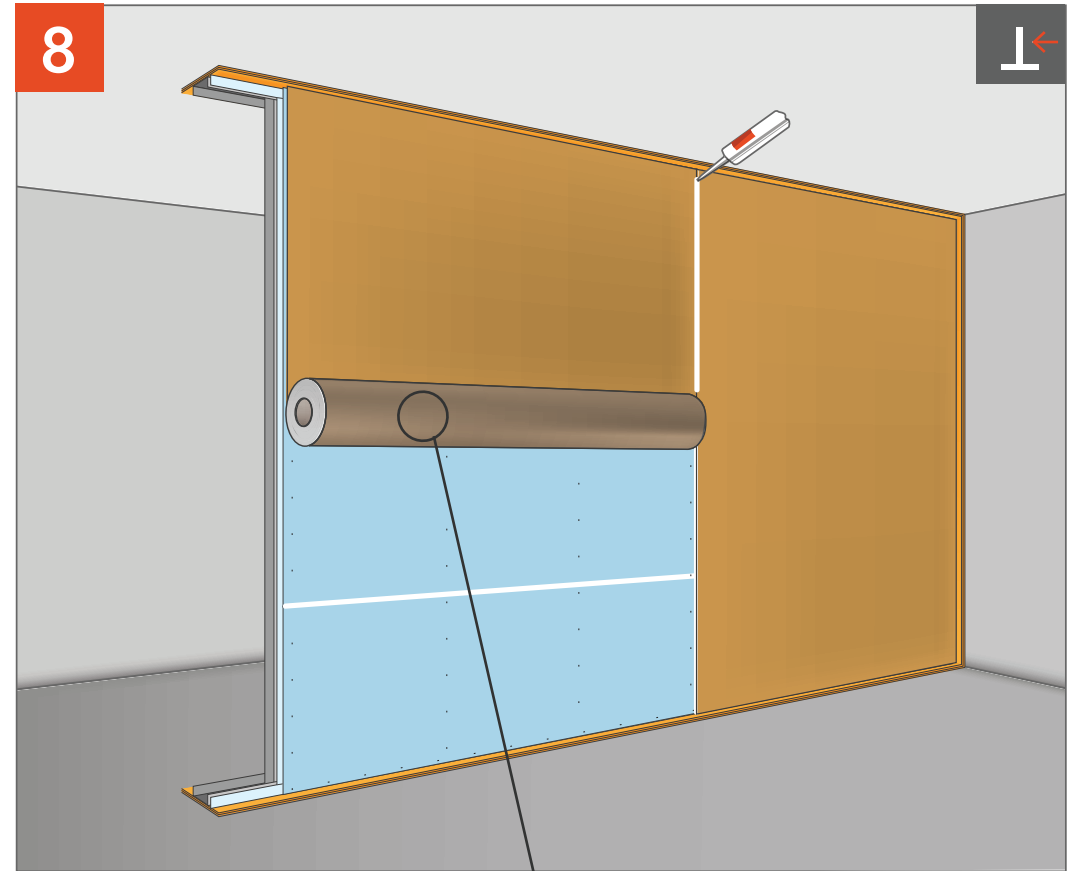

Glue a sound insulation membrane on the AcousticGypsum GKZ sheets and cover the joints with Sonetik vibroacoustic sealant.

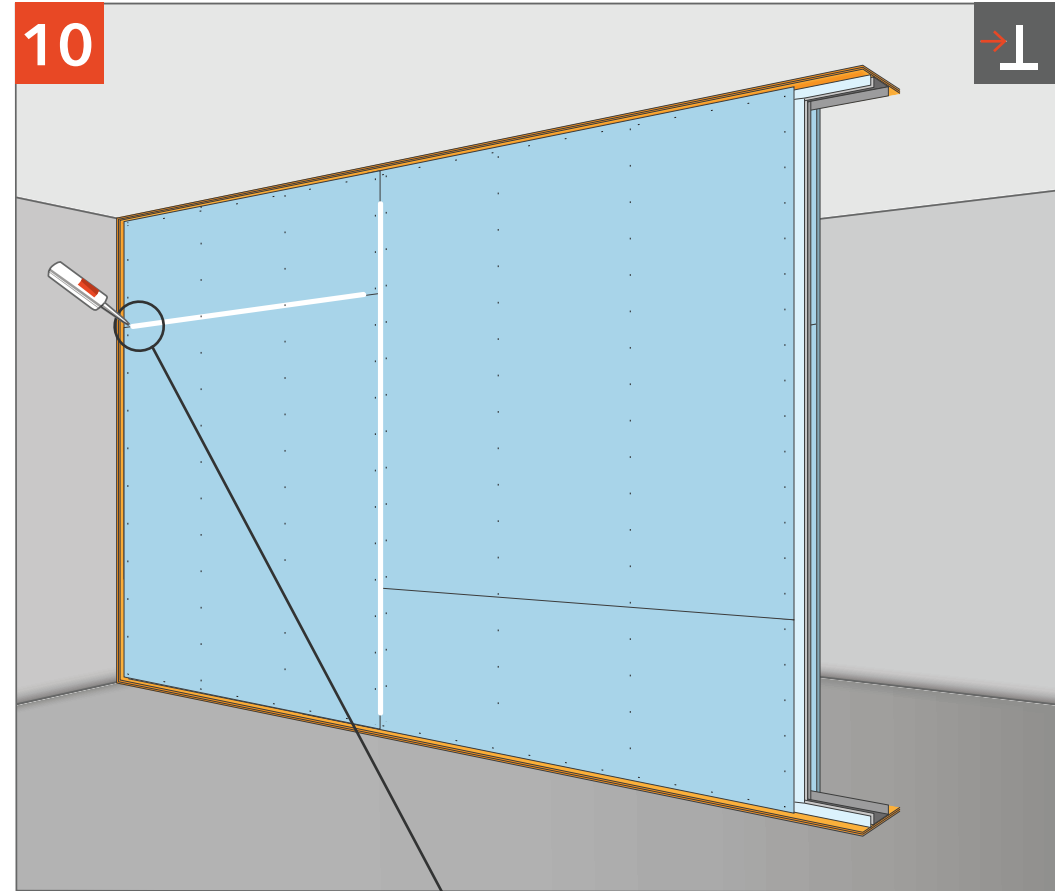
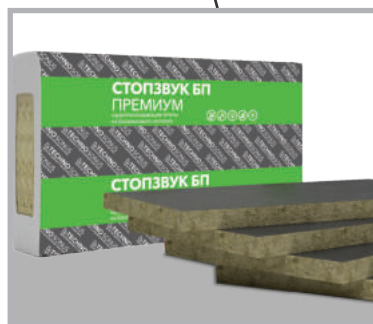
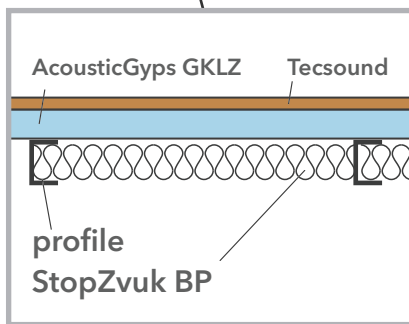
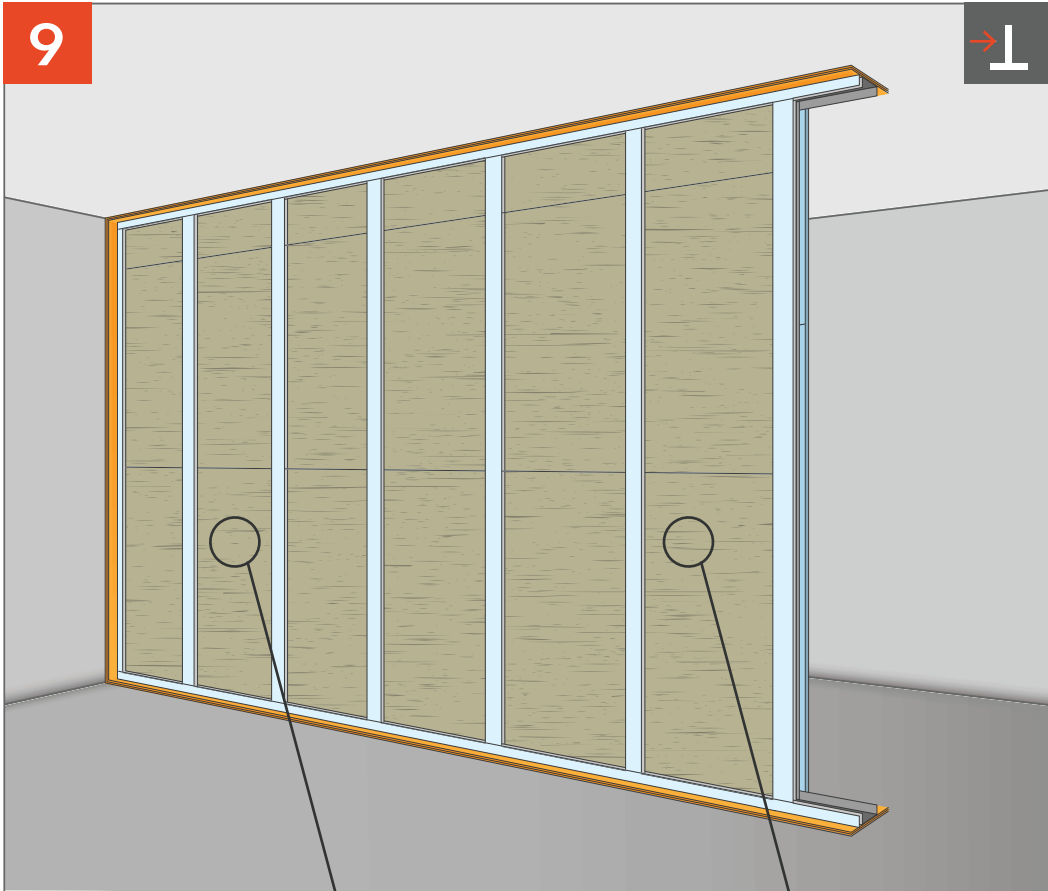

Fill the frame with StopZvuk BP boards.

Mount AcousticGypsum GKLZ and cover the joints of the sheets with Sonetik vibroacoustic sealant.

## STANDARD M PARTITION SOUND INSULATION

# STANDARD M PARTITION SOUND INSULATION

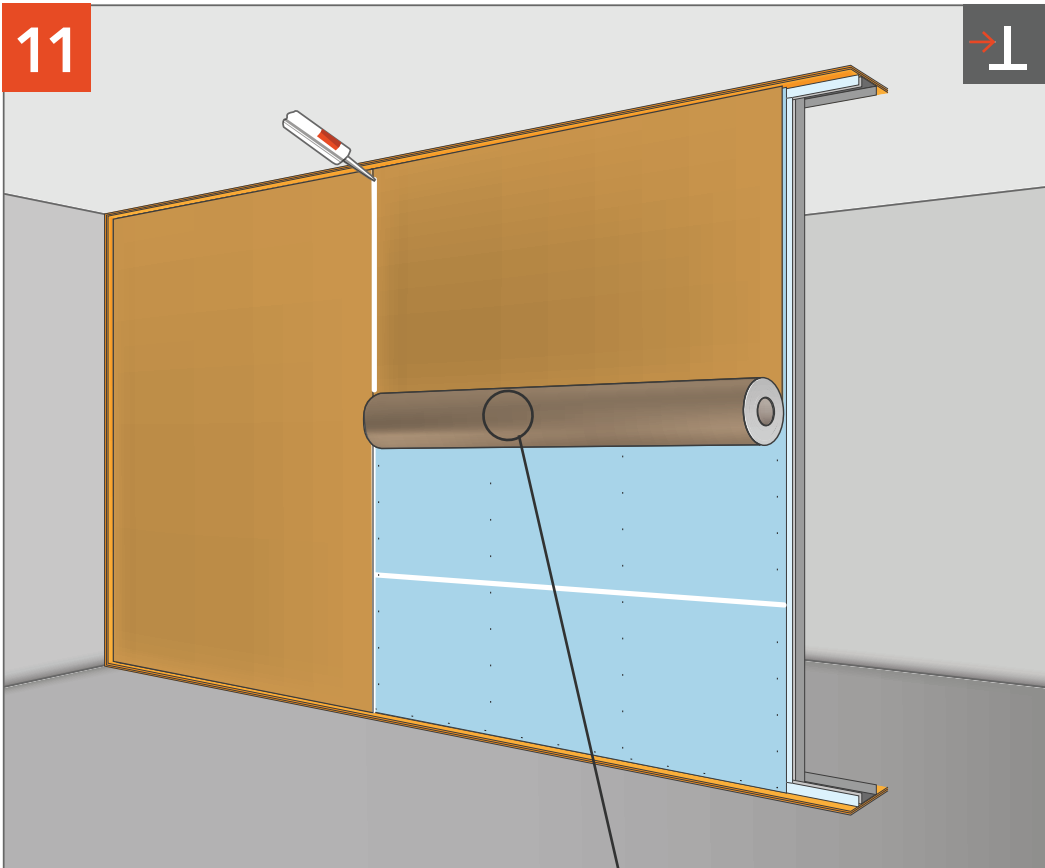

Glue a sound insulation membrane on the AcousticGypsum GKZ sheets and cover the joints with Sonetik vibroacoustic sealant.

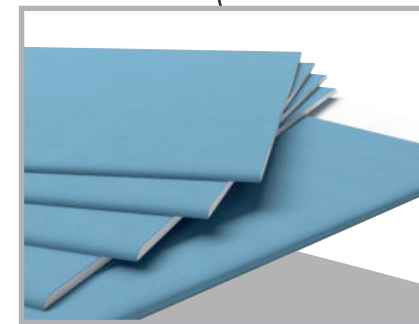
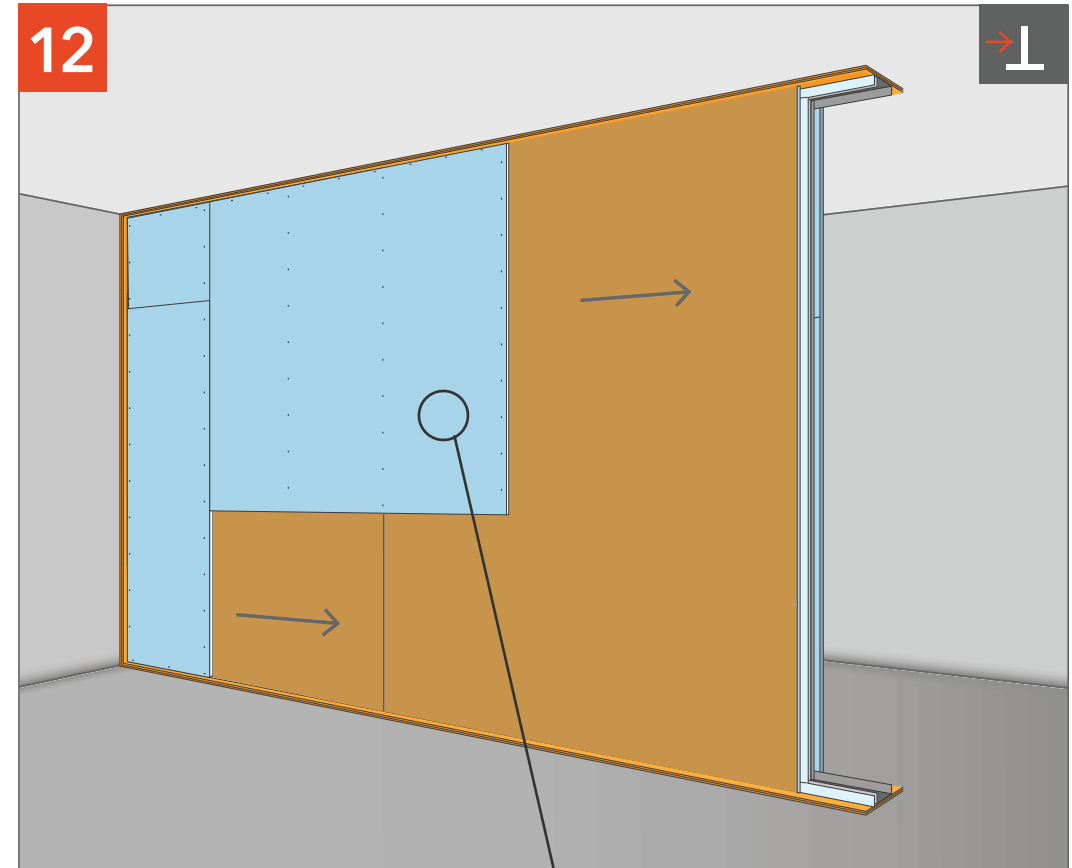

Mount one more AcousticGyps GKZ layer.

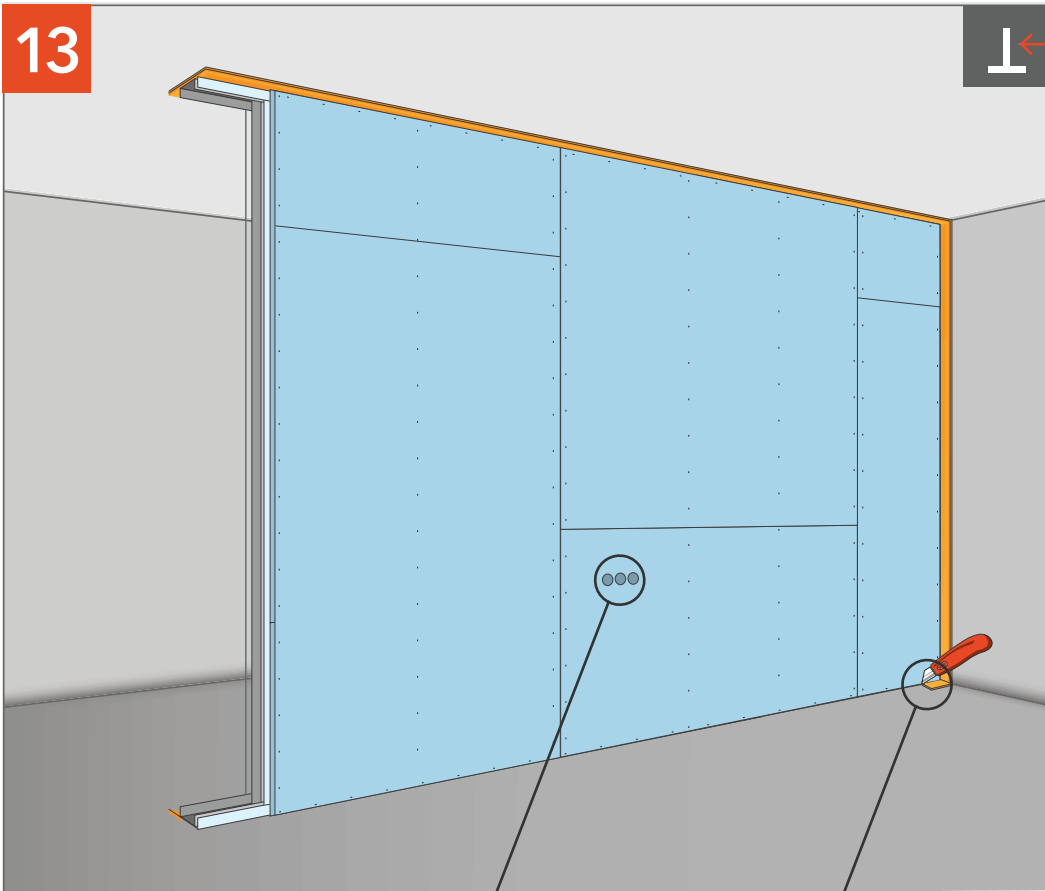

Remove excess of StopZvuk V100 tape.

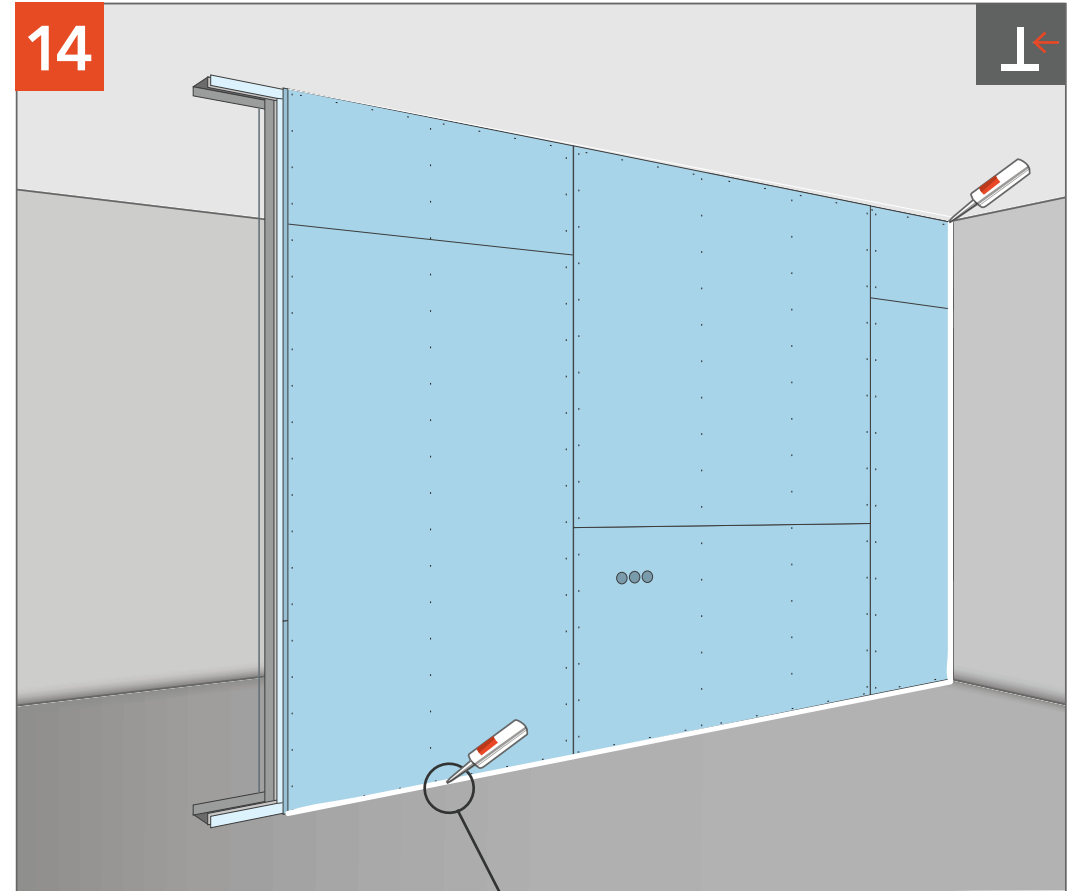

Apply Sonetik sealant around the perimeter.

## STANDARD M PARTITION SOUND INSULATION